

VALVOLE serie CETOP

A SPOLA BILANCIATA

VALVES series CETOP

BALANCED SPOOL

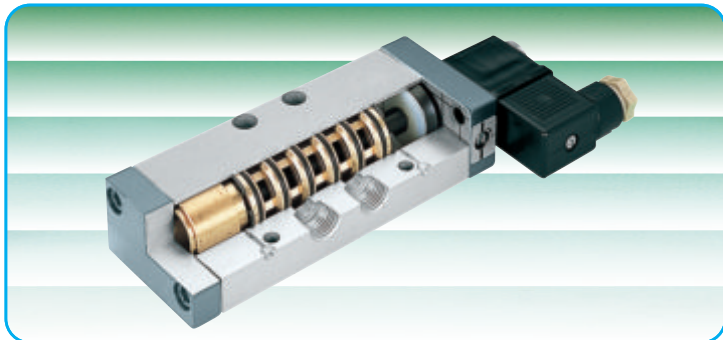

DATI TECNICI

TECHNICAL DATA

Fluido Fluid	Aria filtrata Filtered air
Lubrificazione Lubrication	Con o senza lubrificazione (in aria umida) With or without lubrication (moist air)
Lubrificante Lubricant	Compatibile con NBR (3°±10° E) classe H Compatible with NBR (3°±10° E) class H

LE PORTATE

FLOW RATES

Taglia Size	Connessione Connection	Portata Flow rate NI/min				
A	1/8" - 1/4"	510	610	720	840	960
B	1/4" - 3/8"	880	1080	1320	1560	1780
C	1/2"	2400	2950	3500	4050	4600
Pressione Pressure	bar	3	4	5	6	7

CARATTERISTICHE COSTRUTTIVE

CONSTRUCTIVE FEATURES

Connessione Connection	1/8" - 1/4" - 3/8" - 1/2"
Vie Ways	5/2 - 5/3
Funzioni Functions	Pneumatica - Elettrica Pneumatic - Solenoid
Corpo Body	Trafilato in Al anodizzato Drawn Al - anodized
Spola Spool	In Al anodizzato rullato Rolled Al - anodized
Guarnizioni Seals	Gomma nitrilica NBR Nitrilic rubber NBR
Fissaggio Mounting	Fori corpo valvola / Su collettori multipli Holes in valve body / On manifolds
Elettropilota con azionamento manuale Solenoid operators - manually operated	Posizioni stabili Detented

CARATTERISTICHE TECNICHE

TECHNICAL FEATURES

Denominazione Denomination		Taglia Size		
		A	B	C
		1/8"-1/4"	1/4"-3/8"	1/2"
Diametro nominale Nominal diameter	mm	5	8	12
Pressione di esercizio Operating pressure	bar	1÷10		
Pressione min. di pilotaggio Min. pilot pressure	bar	2		
Temperatura di esercizio Temperature range		-10°C + 60°C		
Installazione Installation		in ogni posizione in any position		

CARATTERISTICHE ELETTRICHE

ELECTRICAL FEATURES

Versioni Versions	5 W
Potenza assorbita Power consumption	5 W
Tensioni DC Voltage DC	12-24-48-110 V
Tensioni AC Voltage AC	24-48-110-220 V - 50÷60 Hz
Durata inserimento Duty cycle	100%
Tolleranza tensione Permissible voltage fluctuation	-10%; +15%
Tipo di protezione Protection	IP-65 DIN 43650 PG 9
Connettore Connector	2 posizioni a 180° 2 positions 180°

A richiesta bobine con assorbimento 2,5 W
Coils with consumption 2,5W upon request

DISTRIBUTORI AD AZIONAMENTO PNEUMATICO 5/2 - 5/3
PNEUMATICALLY ACTUATED VALVES 5/2 - 5/3

MONOSTABILI PNEUMATICHE
 PNEUMATIC PILOT-SPRING



MONOSTABILI MOLLA MECCANICA
 MECHANICAL SPRING



BISTABILE PNEUMATICHE
 PNEUMATIC DOUBLE-PILOT

BISTABILE PNEUMATICHE CENTRI CHIUSI
 DOUBLE-PILOT PNEUMATIC SPRING CENTERED-CLOSED

BISTABILE PNEUMATICHE CENTRI APERTI
 DOUBLE-PILOT PNEUMATIC SPRING CENTERED-EXHAUSTED

Simbolo Symbol	Taglia Size	Connessione Connection	Vie Ways	Peso Weight g	Codice Code
	A	1/8"	5/2	235	DC-138010
		1/4"			DC-138010/4
	B	1/4"	5/2	480	DC-134010
		3/8"			DC-134010/3
	C	1/2"	5/2	1300	DC-132010

Simbolo Symbol	Taglia Size	Connessione Connection	Vie Ways	Peso Weight g	Codice Code
	A	1/8"	5/2	245	DC-138040
		1/4"			DC-138040/4
	B	1/4"	5/2	495	DC-134040
		3/8"			DC-134040/3
	C	1/2"	5/2	1320	DC-132040

Simbolo Symbol	Taglia Size	Connessione Connection	Vie Ways	Peso Weight g	Codice Code
	A	1/8"	5/2	270	DC-138020
		1/4"			DC-138020/4
	B	1/4"	5/2	510	DC-134020
		3/8"			DC-134020/3
	C	1/2"	5/2	1350	DC-132020

Simbolo Symbol	Taglia Size	Connessione Connection	Vie Ways	Peso Weight g	Codice Code
	A	1/8"	5/3	290	DC-518020
	B	1/4"	5/3	530	DC-514020
	C	1/2"	5/3	1390	DC-512020

Simbolo Symbol	Taglia Size	Connessione Connection	Vie Ways	Peso Weight g	Codice Code
	A	1/8"	5/3	290	DC-538020
	B	1/4"	5/3	530	DC-534020
	C	1/2"	5/3	1390	DC-532020

DISTRIBUTORI AD AZIONAMENTO ELETTRICO 5/2 - 5/3
SOLENOID OPERATED VALVES 5/2 - 5/3



MONOSTABILE
ELETTRICA
SOLENOID
PILOT-SPRING

Simbolo Symbol	Taglia Size	Connessione Connection	Vie Ways	Peso Weight g	Codice Code
	A	1/8"	5/2	320	EC-13801 L/E
		1/4"			EC-13801/4 L/E
	B	1/4"	5/2	630	EC-13401 L/E
		3/8"			EC-13401/3 L/E
C	1/2"	5/2	1500	EC-13201 A/E	



MONOSTABILE
ELETTRICA
MOLLA
MECCANICA
SOLENOID
MECHANICAL
SPRING

Simbolo Symbol	Taglia Size	Connessione Connection	Vie Ways	Peso Weight g	Codice Code
	A	1/8"	5/2	320	EC-13804 L/E
		1/4"			EC-13804/4 L/E
	B	1/4"	5/2	630	EC-13404 L/E
		3/8"			EC-13404/3 L/E
C	1/2"	5/2	1500	EC-13204 A/E	



BISTABILE
ELETTRICA
SOLENOID
DOUBLE-PILOT

Simbolo Symbol	Taglia Size	Connessione Connection	Vie Ways	Peso Weight g	Codice Code
	A	1/8"	5/2	420	EC-13802 L/E
		1/4"			EC-13802/4 L/E
	B	1/4"	5/2	710	EC-13402 L/E
		3/8"			EC-13402/3 L/E
C	1/2"	5/2	1600	EC-13202 A/E	

BISTABILE
ELETTRICA
CENTRI CHIUSI
SOLENOID
DOUBLE-PILOT
SPRING CENTERED-
CLOSED

Simbolo Symbol	Taglia Size	Connessione Connection	Vie Ways	Peso Weight g	Codice Code
	A	1/8"	5/3	420	EC-51802 L/E
	B	1/4"	5/3	710	EC-51402 L/E
	C	1/2"	5/3	1600	EC-51202 A/E

BISTABILE
ELETTRICA
CENTRI APERTI
SOLENOID
DOUBLE-PILOT
SPRING CENTERED-
EXHAUSTED

Simbolo Symbol	Taglia Size	Connessione Connection	Vie Ways	Peso Weight g	Codice Code
	A	1/8"	5/3	420	EC-53802 L/E
	B	1/4"	5/3	710	EC-53402 L/E
	C	1/2"	5/3	1600	EC-53202 A/E

SOTTOBASI MANIFOLDS



Sono forniti completi di viti di collegamento.
Supplied complete with fixing screws.

Valvola Valve	Connessione Connection	Codice Code						
A	1/8"	BCR 82	83	84	85	86	87	88
A	1/4"	BCR 12	13	14	15	16	17	18
B	1/4"	BCR 42	43	44	45	46	47	48
B	3/8"	BCR 22	23	24	25	26	27	28
N° delle posizioni No. of stations		2 posti pos.	3 posti pos.	4 posti pos.	5 posti pos.	6 posti pos.	7 posti pos.	8 posti pos.

COLLETTORI DI LINEA IN LINE MANIFOLDS



Sono forniti completi di viti di collegamento e piedini di fissaggio.
Supplied complete with fixing screws and mounting feet.

Valvola Valve	Connessione Connection	Codice Code				
A	1/8"	CT 602	603	604	605	606
A	1/4"	CT 612A	613A	614A	615A	616A
B	1/4"	CT 612B	613B	614B	615B	616B
B	3/8"	CT 622	623	624	625	626
N° delle posizioni No. of stations		2 posti positions	3 posti positions	4 posti positions	5 posti positions	6 posti positions

BOBINA 5 W
COIL
Cod. BOB E...*Code



CONNETTORE
CONNECTOR
Cod. CNN-1
Code



* Indicare la tensione.
A richiesta bobine con assorbimento 2,5 W.
* Quote voltage.
Coils with consumption 2,5 W upon request.

VITI PER ALIMENTAZIONE SEPARATA
PIASTRE DI ESCLUSIONE
HOLLOW BOLT FOR SEPARATE AIR CONNECTION
BLANKING PLATES

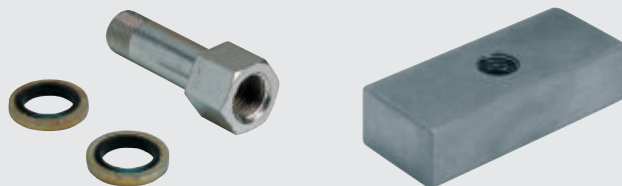

Valvola Valve	Taglia Size	Codice viti Code bolts	Codice piastre Code plates
A	1/8"	10243	10240
A	1/4"	10481	
B	1/4"	10249	10246
B	3/8"	10482	

TAGLIA A - 1/8"
SIZE A - 1/8"

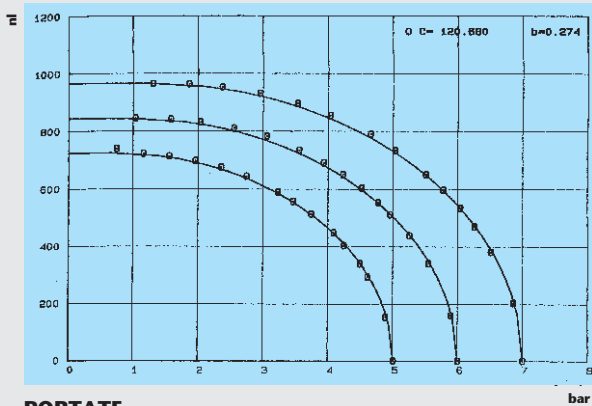

PORTATE
FLOW RATES

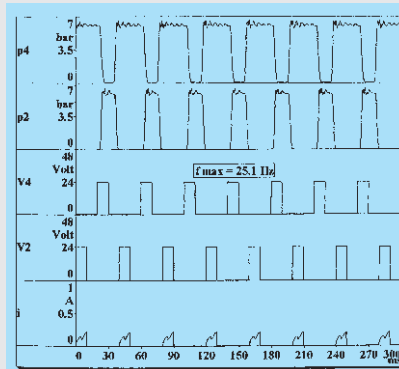

FREQUENZA MAX
MAX. FREQUENCY

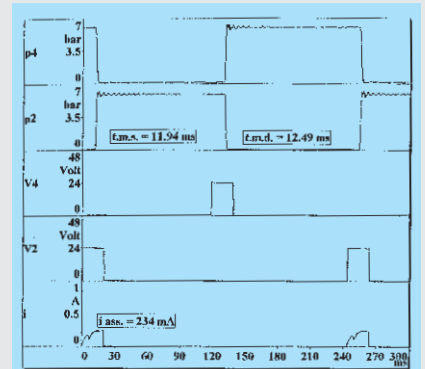

TEMPI E ASSORBIMENTI
TIME AND POWER INPUT

TAGLIA A - 1/4"
SIZE A - 1/4"

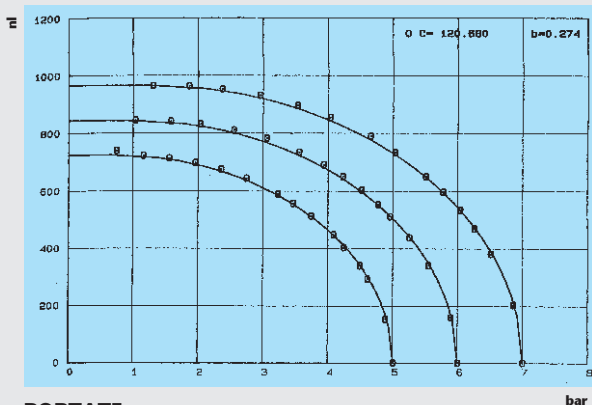

PORTATE
FLOW RATES

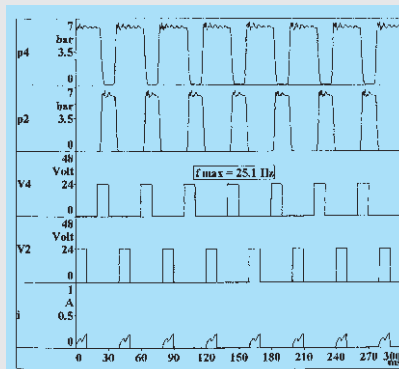

FREQUENZA MAX
MAX. FREQUENCY

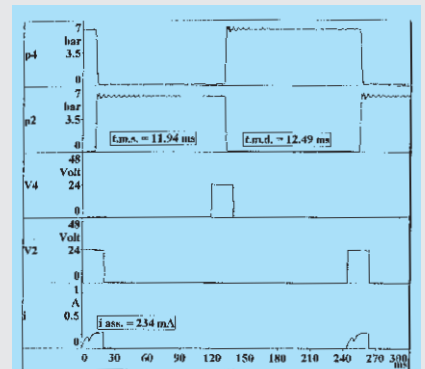

TEMPI E ASSORBIMENTI
TIME AND POWER INPUT

Dati rilevati da
Data surveyed by



Dipartimento
di Meccanica
Politecnico di Torino



Cert. n. 5/94

TAGLIA B - 1/4"
SIZE B - 1/4"

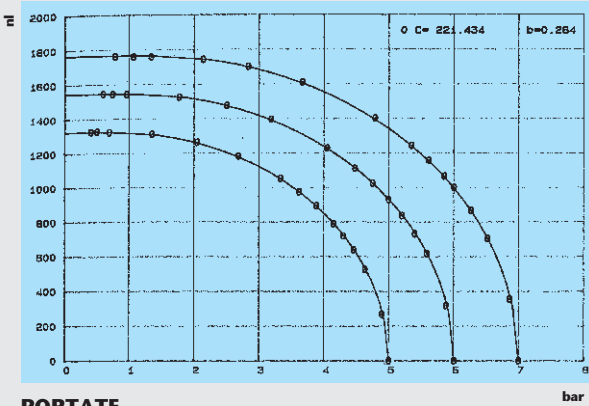

PORTATE
FLOW RATES

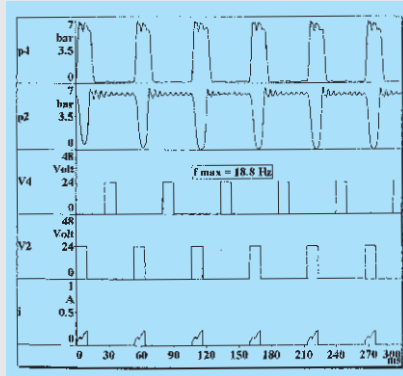

FREQUENZA MAX
MAX. FREQUENCY

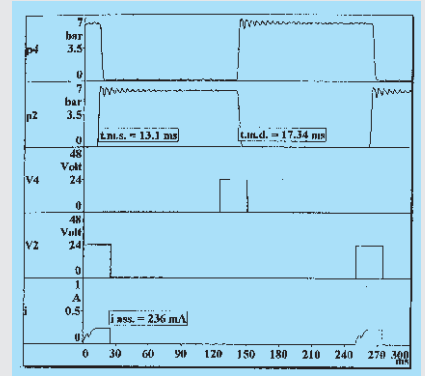

TEMPI E ASSORBIMENTI
TIME AND POWER INPUT

TAGLIA B - 3/8"
SIZE B - 3/8"

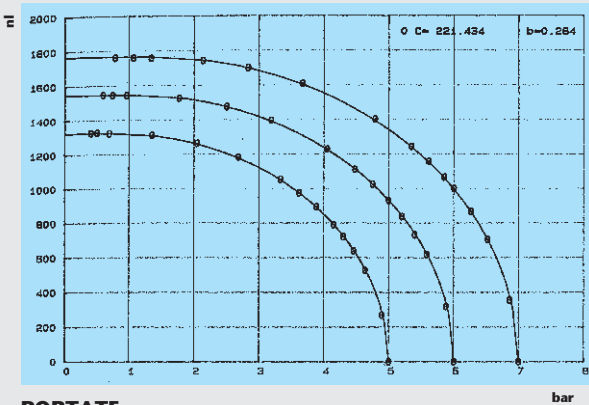

PORTATE
FLOW RATES

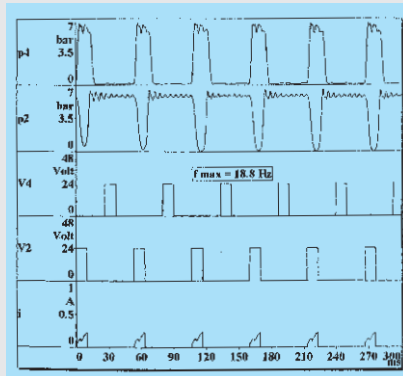

FREQUENZA MAX
MAX. FREQUENCY

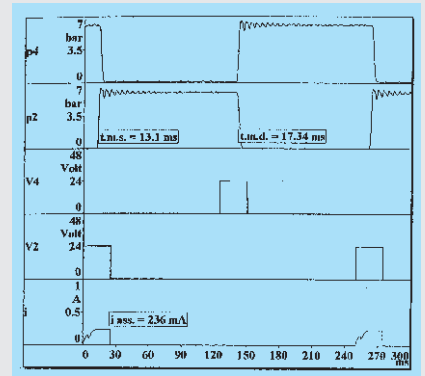

TEMPI E ASSORBIMENTI
TIME AND POWER INPUT

TAGLIA C - 1/2"
SIZE C - 1/2"

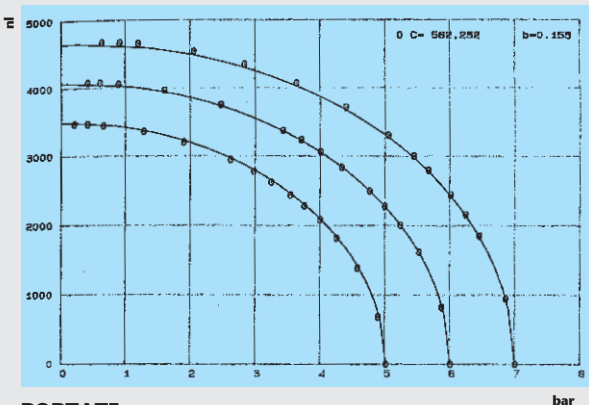

PORTATE
FLOW RATES

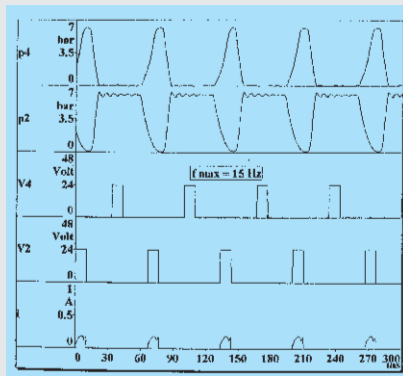

FREQUENZA MAX
MAX. FREQUENCY

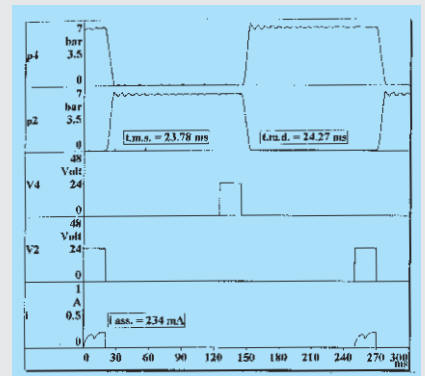

TEMPI E ASSORBIMENTI
TIME AND POWER INPUT

serie CETOP

CARATTERISTICHE DIMENSIONALI

series CETOP

DIMENSIONS

MONOSTABILI PNEUMATICHE

5/2 - 5/3 vie

PNEUMATIC - PILOT-SPRING

2/2 - 3/2 ways

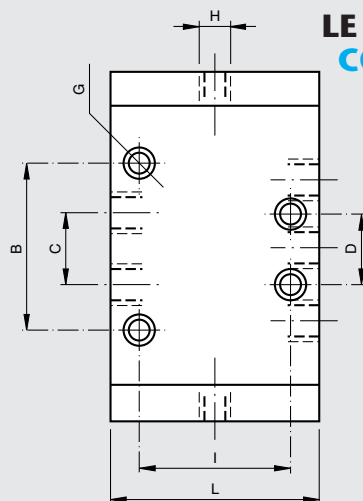
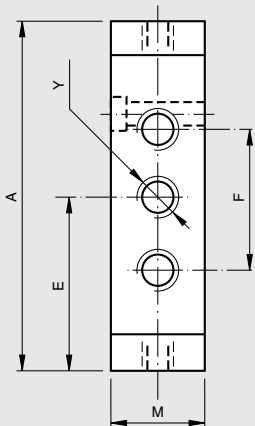
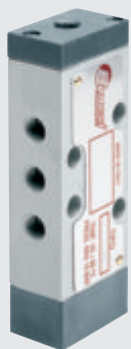

LE DIMENSIONI COMUNI

COMMON DIMENSIONS

Taglia Connessione
Size Connection

Taglia Size	Connessione Connection	A	B	C	D	E	F	G	H	I	L	M
A	1/8"-1/4"	104	36	18	18	52	36	4,5	1/8"	26	40	25
B	1/4"-3/8"	134	60	22	22	67	44	5,5	1/8"	40	52	30
C	1/2"	184	108	40	40	92	80	6,5	1/8"	50	70	35

Codice famiglie
Family code

Versione
Version

DC-13	010
DC-51	020
DC-53	040

MONOSTABILI - MOLLA MECCANICA

5/2 - 5/3 vie

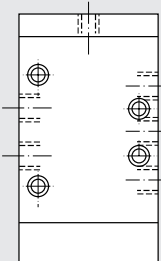
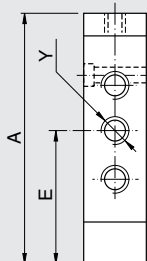

MECHANICAL SPRING

5/2 - 5/3 ways

Taglia Size	A	E	Codice Famiglie Code	Versione
A	113	61	DC-13	040
B	143	76		
C	193	101		

BASI MONTAGGIO IN BATTERIA MANIFOLD

SUB-BASES FOR MANIFOLD MOUNTINGS

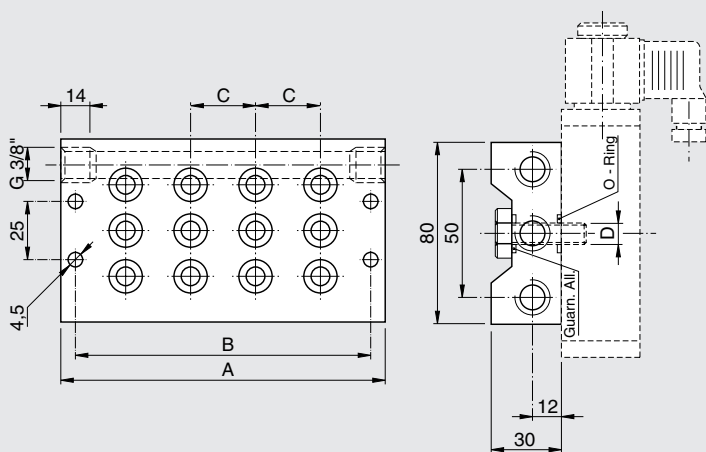

Taglia valvola Size valve	2 posti pos.	3 posti pos.	4 posti pos.	5 posti pos.	6 posti pos.	7 posti pos.	8 posti pos.
A	A	81	108	135	162	189	243
	1/8" B	69	96	123	150	177	231
	1/4" C	27					
	D	G1/8"					
B	A	108	140,5	173	205,5	238	270,5
	1/4" B	96	128,5	161	193,5	226	258,5
	3/8" C	32,5					
	D	G1/4"					

BISTABILI ELETTRICHE
5/2 - 5/3 vie

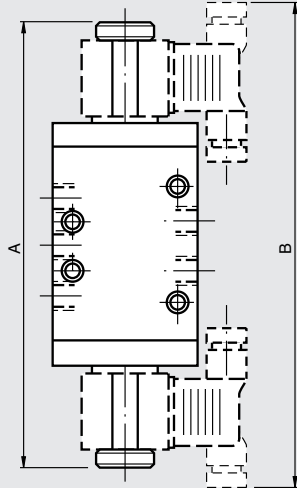

SOLENOID DOUBLE PILOT
5/2 - 5/3 ways

Connessione Connection	A	B	Codice famiglie Family code	Versione Version
1/8"-1/4"	177	207	EC-13	02 L/E
1/4"-3/8"	203	233	EC-51	02 L/E

MONOSTABILI ELETTRICHE
5/2 vie

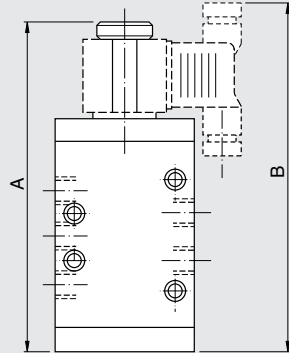

SOLENOID - PILOT-SPRING
5/2 ways

Connessione Connection	A	B	Codice famiglie Family code	Versione Version
1/8"-1/4"	140	155,5	EC-13	01 L/E
1/4"-3/8"	168	185,5	EC-51	04 L/E

MONOSTABILI-BISTABILI ELETTRICHE
5/2 - 5/3 vie

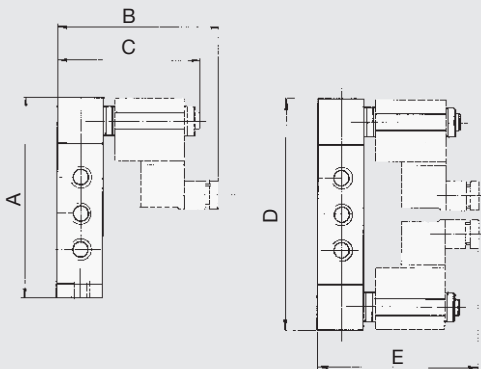

SOLENOID - PILOT SPRING-DOUBLE PILOT
5/2- 5/3 ways

Connessione Connection	A	B	C	D	E	Codice famiglie Family code	Versione Version
1/2"	192	85	70	200	85	EC-13	01A/E
						EC-51	02A/E

COLLETTORI DI LINEA
IN LINE MANIFOLDS

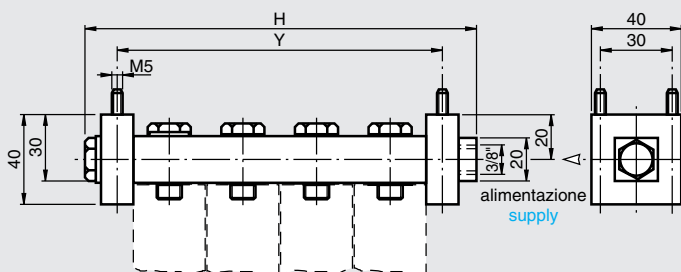

Connessione Connection		2 posti pos.	3 posti pos.	4 posti pos.	5 posti pos.	6 posti pos.	Alimentazione Supply
A	1/8" H	87	110	133	156	179	3/8"
	1/4" Y	60	83	106	129	152	
B	1/4" H	107	140	173	206	239	
	3/8" Y	80	113	146	179	212	